

# ADESSO

PROFESSIONAL FM TRANSCEIVER

## TP-3200

## INSTRUCTION MANUAL

\* Please carefully read before use



Thank you for purchasing our hand held FM transceiver. This model is novel designed with stable performance and we want to develop this model to be a portable equipment, also easy to operate with a variety of sophisticated functions, so we are using the most advanced technology. We deeply confident that its quality and functionality would make you feel satisfied!

In order to make you fully understand the equipment, please read this user manual before using.

## PRECAUTION

The transceiver is a product with good design and advanced technology. The following suggestions will help you perform the obligations of warranty cause, understand and realize the security of using transceivers.

1. Put transceiver and all its parts and accessories in place out of children's reach.
2. Do not try to disassemble transceiver as non-professional's treatment to the transceiver may cause damage.
3. Please use our company's assorted battery pack and charger, avoid damage to transceiver.
4. Please use our company's assorted antenna, to prevent shorten communication distance.
5. Do not expose transceiver to sunlight for a long time or in the overheated areas.
6. Do not put transceiver in dusted or wet areas.
7. Do not clean transceiver with strong chemicals, cleaning agents or strong lotion.
8. Do not transmit unless the antenna has been installed.
9. If you discover the transceiver giving off odor or smoke, please immediately turn off the power of transceiver, remove battery pack from transceiver and contact with dealers.

## ANNOUNCEMENT

- » All the proposals above are equally applicable to your transceiver and its accessories. If they can not work properly, please contact with dealers promptly.
- » If you use accessories which are not produced or sold by our company, We will not guarantee the safety and operability of the transceiver.

## CONTENTS

<b>UNPACKING AND CHECKING EQUIPMENT</b> .....	<b>1</b>
Assorted Accessories .....	1
<b>PREPARATION</b> .....	<b>2</b>
Charging the Battery Pack .....	2
Installing/Removing the Battery Pack.....	4
Installing the Antenna .....	5
Installing the Belt Clip .....	5
Installing the Optional Speaker/Microphone .....	5
<b>GETTING ACQUAINTED</b> .....	<b>6</b>
<b>OPERATION</b> .....	<b>7</b>
<b>AUXILIARY FUNCTIONS</b> .....	<b>8</b>
Time-out Timer.....	8
Battery Power Save.....	8
Low Power Warning .....	8
Monitor.....	9
Quiet Talk (QT) and Digital Quiet Talk (DQT) .....	9
<b>SPECIFICATIONS</b> .....	<b>10</b>
<b>TROUBLESHOOTING GUIDE</b> .....	<b>11</b>
<b>FREQUENCY CHART</b> .....	<b>12</b>

## UNPACKING AND CHECKING EQUIPMENT

Please take the transceiver from the package carefully. We suggest that you should check the following accessories before throwing away the package. If any items is lost or damaged when transportation, please submit a claim to the delivery man immediately.

### Assorted Accessories

Item	Qty.
Antenna	1
Charger	1
Battery	1
Belt Clip	1
Screw Set	1
User Manual	1
Adaptor	1

## PREPARATION

### Charging the Battery Pack

The battery pack is not charged at the factory; Please charge it before using.

After purchasing or long time storage (more than two months), the battery can not reach its normal capacity when charge at the first time. After charging 2-3 times then the capacity reach the normal one.



#### CAUTION

- ◆ Do not recharge the battery pack if it is already fully charged. Otherwise, the battery life will be shorten or damaged.
- ◆ After recharging the battery pack, disconnect it from the charger. Charging the battery pack more than 5 days may reduce the battery pack life due to overcharging.

#### NOTE:

- ◆ The ambient temperature should be between 42 and 104°F (5 to 40°C) while charging is in progress. Charging outside this range may not fully charge the battery.
- ◆ Always switch OFF the transceiver equipped with a battery pack before charging. Using the transceiver while charging will interfere with correct charging.
- ◆ Even after completely correct charge, the using time still not increases, then the battery life is over, please replace the battery.

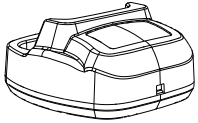

Plug the Charger power cable into an AC outlet.

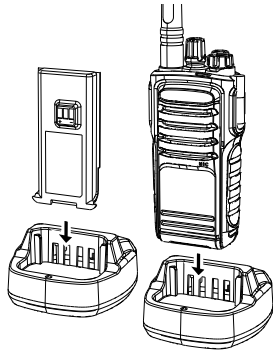

Insert the battery pack or transceiver with a battery pack into the charger.

- ◆ Make sure the battery pack contact with the charging terminals correctly.
- ◆ The charger LED lights on and charging begins.

After charging the assorted battery pack for 4~8 hours, take the battery or the transceiver with battery from the charger.

- ◆ The charge completes when charging light turns green.

Unplug the AC adaptor from the AC outlet.

## Installing/Removing the Battery Pack

The average using time of the supplied battery pack is 8 hours. Average times is calculated by using 5% transmit time, 5% receive time, and 90% standby time.



### CAUTION

- ◆ Do not make the battery terminals short circuit or dispose the battery into fire.
- ◆ Do not try to remove the shell from the battery pack.

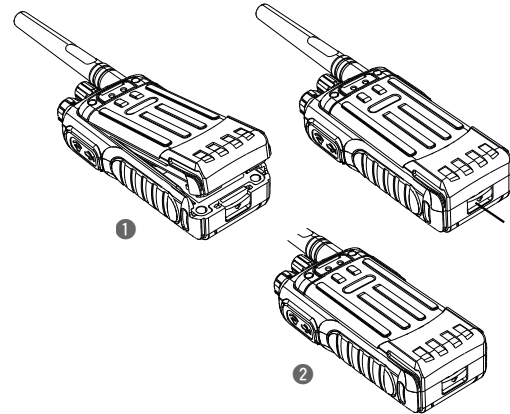

### Battery Latch

Pull the latch downward to remove the battery pack.



## Installing the Antenna

Hold the antenna base and screw the antenna clockwise into the antenna connector at the top of the transceiver, until tighten.

**NOTE:** Don't hang keys, speaker or microphone on the antenna. Otherwise the antenna will be damaged or performance of the radio will be degraded.

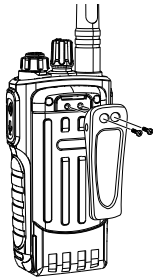

## Installing the Belt Clip

If necessary, can use two 3 x 8mm screws in the package to fix the belt clip.

### NOTE:

- ◆ If not install the belt clip, its installation location will get hot in the hot environment or in the continuous communication.
- ◆ You must remove the belt clip before removing the battery pack.

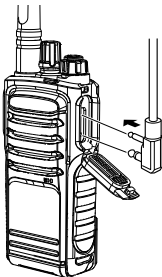

## Installing the Optional Speaker/ Microphone

Outward apart the moisture-proof rubber of the headphone mouth, Insert the speaker/ microphone plugs into the speaker/microphone jacks.

**NOTE:** The transceiver is not fully waterproof while using the speaker/microphone.

### Antenna

### LED indicator

Lights red while transmitting.  
Lights green while receiving a signal.  
Purple light flashing when transmit with low battery power.

### Speaker

### Microphone

### Channel

### PTT (Push-To-Talk) Switch

Press, then speak into the microphone to call. Release to receive.

### Monitor key

Press and hold to turn the squelch OFF. You will hear background noise. Release to turn the squelch ON.

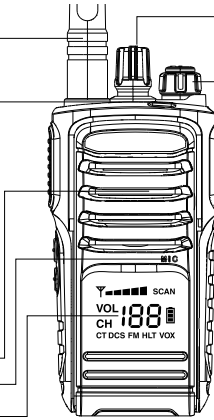

### Channel selector

Rotate to select channels 1~199.

### Power switch/ Volume control

Turn clockwise to switch ON the transceiver. To switch OFF the transceiver, turn counterclockwise until a click sounds. Rotate to adjust the volume level.

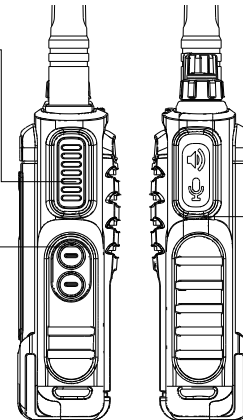

### Speaker/ Microphone jacks

### Battery pack

## OPERATION



Switch ON the transceiver by turning the **Power switch/Volume control** clockwise.

- ◆ A beep sounds.

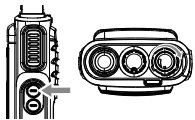

Adjust the volume by rotating the **Volume control**.

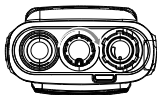

Rotates the **Channel switch** to select channel.

- ◆ When you receive an appropriate signal, you will hear audio from the speaker.

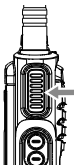

To make a call, press and hold the **PTT switch**, then speak into the microphone using your normal speaker voice.

- ◆ Keep the microphone approximately 1.5 inches (3 to 4cm) from your lips.

Release the **PTT switch** to receive signal.

**NOTE:** If the battery voltage gets low, transmit will stop, status light will flashing red.

## AUXILIARY FUNCTIONS

### Time-out Timer

The purpose of the Time-out Timer is to prevent any person from using a channel for an extended period of time.

If you continuous transmitting 60 seconds, transceiver will stop transmitting and beep sound comes out.

To stop the beep sound, release PTT button. Press the PTT button again then can transmit regain.

### Battery Power Save

Power saving function is to reduce the power consumption when not receive signal or not operation (no press buttons or switch on/off the power.)

If the channel is not busy or not operation more than 10 minutes, the battery power saving function ON. When receive signal or during operation, the battery power saving function automatically OFF.

### Low Power Warning

Low Battery Warning alerts you when the battery needs to be re-charged.

If the battery low to the preset value when you are transmitting, the red lights will flash. If the beep sound comes out, transmit will stop. Please replace the battery or charge.

## Monitor

If no signal occurs, the transceiver squelch circuit will automatically make the speaker silence, so you will not hear background noise. To manually turn off the squelch circuit, hold the Monitor button. This operation is helpful for you to adjust the volume level or receive a weak signal.

- ◆ The LED indicator lights green while the Monitor button is pressed.

## Quiet Talk (QT) and Digital Quiet Talk (DQT)

Some channels may have preset QT/DQT tones. A QT/DQT tone is a subaudible tone which allows you to ignore (not hear) calls from other parties who are using the same channel.

When you receive a signal that has a tone different from the one set up in your transceiver, you will not hear the signal. Likewise, signals that you transmit will only be heard by parties whose QT/DQT tone matches the tone set up in your transceiver.

**NOTE:** Although using channels set up with QT/DQT tones relieves you from listening to unwanted calls, it does not mean your calls will be private.

Unity Section	
Frequency range	400~480MHz
Rated voltage	DC 7.4V (Li-ion battery)
Memory channel	16 channels
Antenna disposition	inductively loaded antenna
Antenna impedance	50Ω
Working manner	same frequency single operation or different frequency single operation
Dimension	125×65×35mm
Launching Parts	
Modulation mode	frequency modulation
Maximum frequency deviation	≤ ±5kHz
Remanent radiation	< -60dB
Modulation mode (W/N)	16KØF3E, 11KØF3E
Emission current	≤ 1000mA
Receiving Parts	
Sensitivity	< 0.16 μV(12dB SINAD)
Squelch sensitivity	< 0.2 μV
Intermodulation Rejection	50dB
Audio frequency power	≥ 300mW
Receiving current	≤ 100mA
Squelch Standby	20mA

## TROUBLESHOOTING GUIDE

Problem	Solution
No power	<ul style="list-style-type: none"> <li>◆ Battery may run out of power, please update the battery or recharge the battery.</li> <li>◆ The battery pack may not be installed correctly. Remove the battery pack and install it again.</li> </ul>
Battery power off shortly after charging	<ul style="list-style-type: none"> <li>◆ The battery pack life is over. Replace the battery pack with a new one.</li> </ul>
Can not talk to or hear other members in your group	<ul style="list-style-type: none"> <li>◆ Make sure you are using the same frequency and Quiet Talk tone as the other members in your group.</li> <li>◆ Other group members may be too far away. Make sure you are within the working range of the transceivers.</li> </ul>
Other voices (besides group members) are present on the channel	<ul style="list-style-type: none"> <li>◆ Change the Quiet Talk tone. Be sure to change the tone on all transceivers in your group.</li> </ul>

## FREQUENCY CHART

Model Name: \_\_\_\_\_

Serial Number: \_\_\_\_\_

Channel	Transmit Frequency	Receive Frequency	QT/DQT
1			
2			
3			
4			
5			
6			
7			
8			
9			
10			
11			
12			
13			
14			
15			
16			

# GUARANTEE CARD

Model Number: \_\_\_\_\_

Serial Number: \_\_\_\_\_

Purchasing Date: \_\_\_\_\_

Dealer: \_\_\_\_\_ Telephone: \_\_\_\_\_

User's Name: \_\_\_\_\_ Telephone: \_\_\_\_\_

Address: \_\_\_\_\_ Post Code: \_\_\_\_\_

## REMARKS:

1. This guarantee card to be kept by the user, no replenishment if lost.
2. This guarantee card to be filled & chopped by the dealer, or it is invalid.
3. Don't alter the guarantee card, please confirm the serial number on the guarantee card is same as that on the machine.
4. One-year guarantee, BUT charger, battery, ear-phone, antenna and can cable are not under guarantee.
5. The user can get repairing service from the following ways:
  - a. Go to the shop where you buy the machine.
  - b. Our local repairing agent.
  - c. Send to us or visit our company.

Please cut along with this line

**ADESSO**